



# Pico Style Connectors

Series Types: RSME

## Pico Style Male Inserts: Snap-in



- M8 inserts for OEM applications
- Solder and PC mount versions
- Long and short body options
- Snap-in design

### Order Information

Face View Male				
Poles	3	4	3	4
Description	<i>Short body PC mount</i>	<i>Short body PC mount</i>	<i>Long body PC mount</i>	<i>Long body PC mount</i>
Catalog Number	RSMEF 3	RSMEF 4	RSMEJ 3	RSMEJ 4
Description	<i>Short body solder</i>	<i>Short body solder</i>	<i>Long body solder</i>	<i>Long body solder</i>
Catalog Number	RSMEG 3	RSMEG 4	RSMEH 3	RSMEH 4

### Order Information

Face View Male				
Poles	3	4	3	4
Description	<i>PC mount long lead</i>		<i>PC mount short lead</i>	<i>PC mount short lead</i>
Catalog Number	RSME 3	N/A	RSMEK 3	RSMEK 4

Dimensional Data

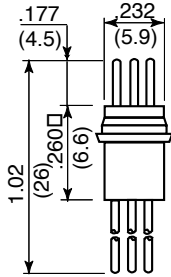

LONG BODY  
RSME

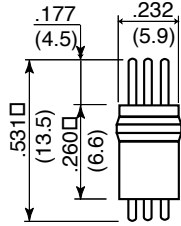

SHORT BODY  
RSMEK

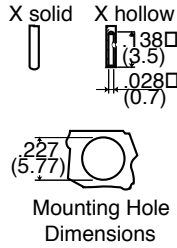

Mounting Hole  
Dimensions

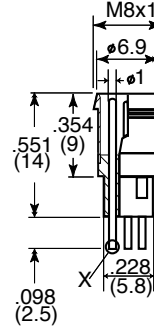

LONG BODY  
RSMEF/RSMEJ

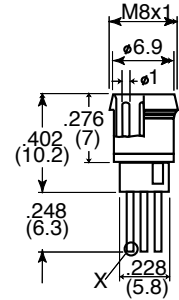

SHORT BODY  
RSMEG/RSMEF

Technical Data

1. Application Class: HNE acc. to DIN 40040  
-25°C to + 90°C ≤75%rF
2. Materials:
  - Contact: Solid- machined brass, gold over nickel plating
  - O-ring for Receptacle: Viton
  - Insert: Nylon
3. Mechanical Data:
  - Protection: Snap-in - IP65, NEMA 4 (only in fully locked position)
4. Electrical Data:
  - Contact Resistance: ≤5mΩ
  - Current Rating: 4A
  - Working Voltage: 60VAC/75VDC
  - Dielectric Withstanding Voltage: 1.5 KVAC RMS/60 seconds
  - Insulation Resistance: >10<sup>9</sup>Ω